

# INSTALLATION MANUAL

## TLALZ Lonzo luminaire

**⚠** This equipment is intended to be installed only by qualified personnel. The installation must be made in accordance with the current edition of the National Electrical Code (NEC) and all applicable state and local building codes. The final installation must be approved by the appropriate, qualified electrical / building inspector(s). Improper installation may result in a fire or electrical hazard. Ensure the electrical power to the circuit has been disconnected before installing the electrical system.

### A. Suspended installation

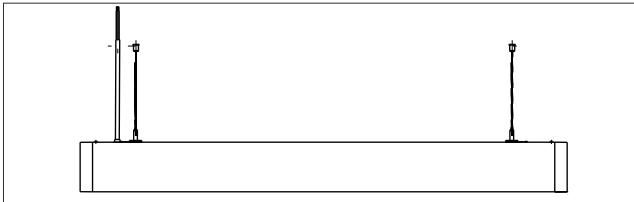

#### Installation Kits

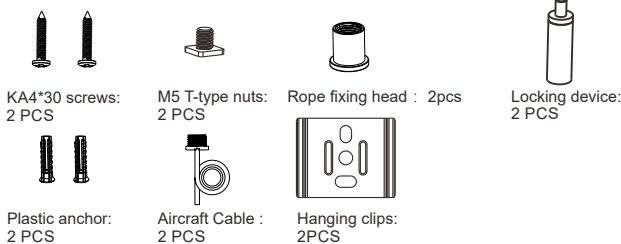

Open the upper light modular

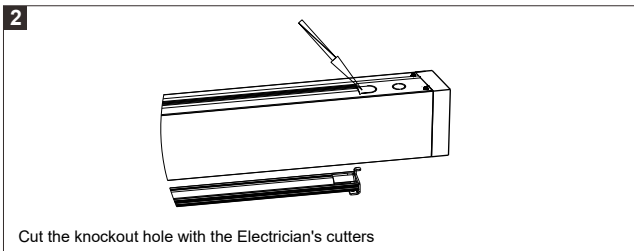
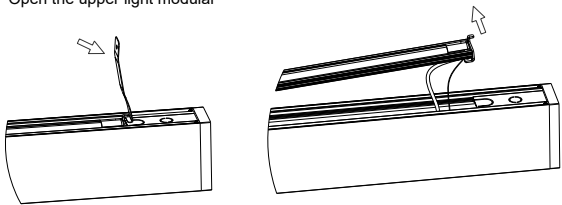

Cut the knockout hole with the Electrician's cutters

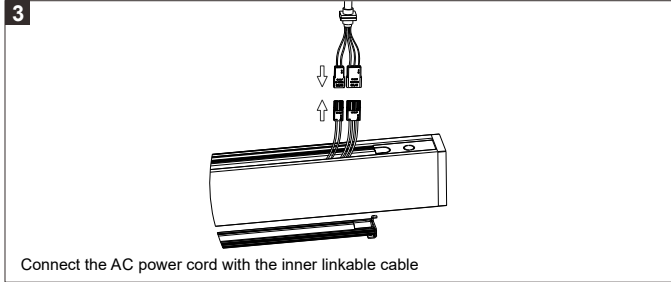

Connect the AC power cord with the inner linkable cable

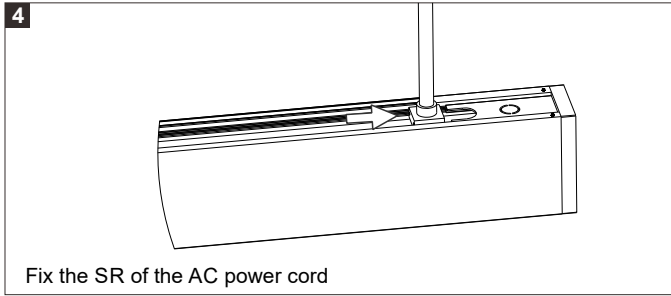

Fix the SR of the AC power cord

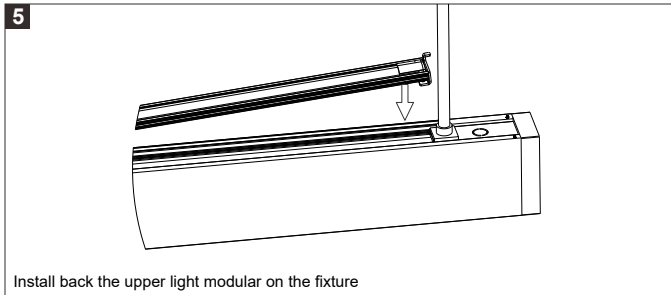

Install back the upper light modular on the fixture

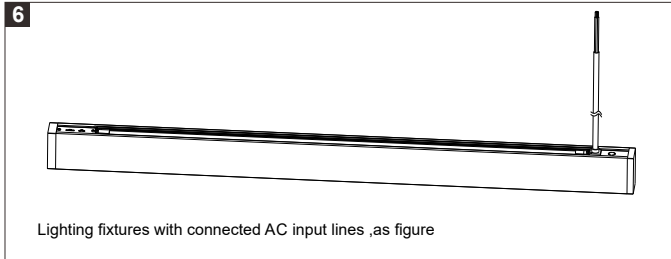

Lighting fixtures with connected AC input lines ,as figure

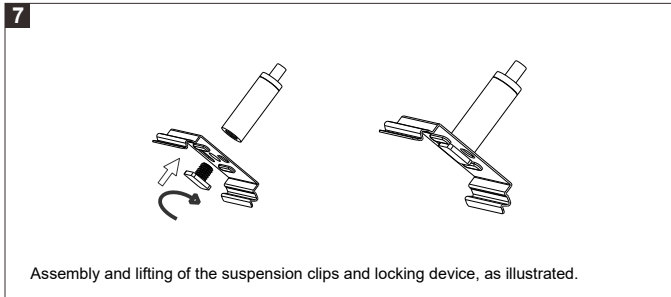

Assembly and lifting of the suspension clips and locking device, as illustrated.

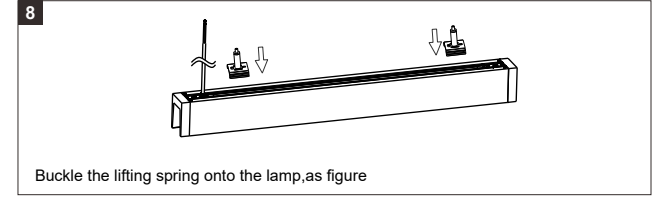

Buckle the lifting spring onto the lamp,as figure

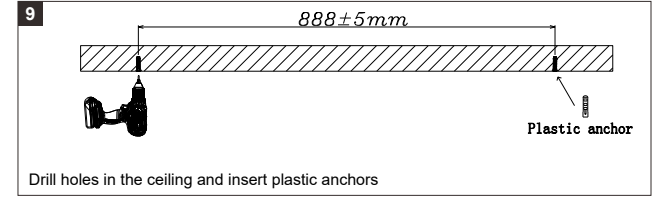

Drill holes in the ceiling and insert plastic anchors

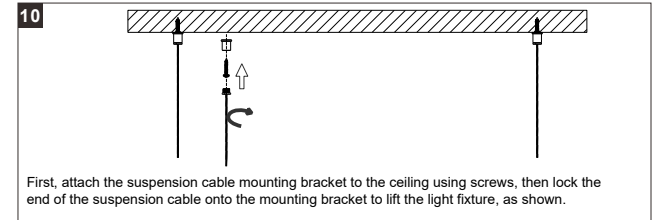

First, attach the suspension cable mounting bracket to the ceiling using screws, then lock the end of the suspension cable onto the mounting bracket to lift the light fixture, as shown.

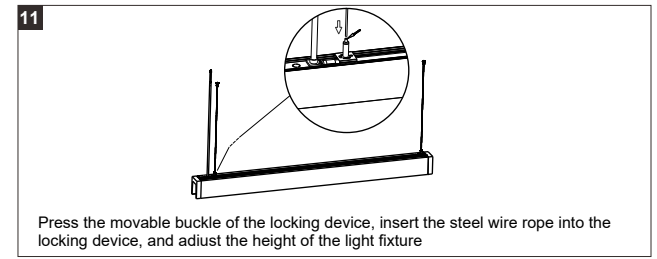

Press the movable buckle of the locking device, insert the steel wire rope into the locking device, and adjust the height of the light fixture

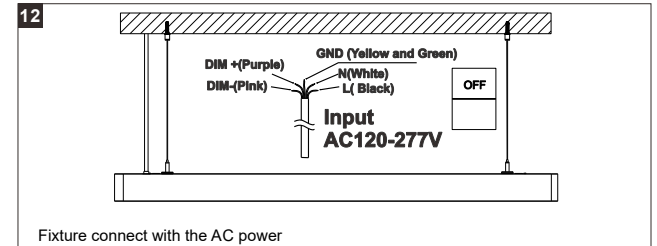

Fixture connect with the AC power

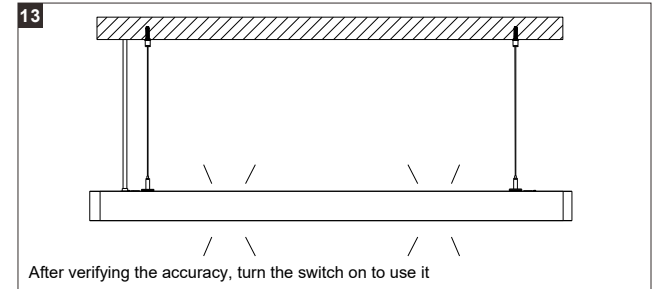

After verifying the accuracy, turn the switch on to use it

## B. Suspended Installation Steps With Canopies

### List of canopy kits

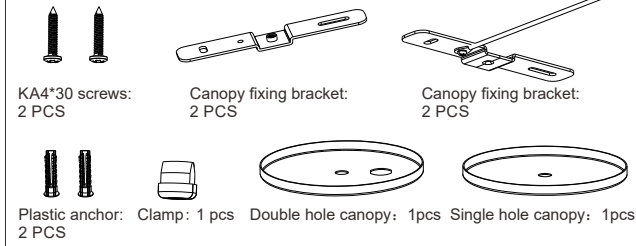

### List of canopy kits

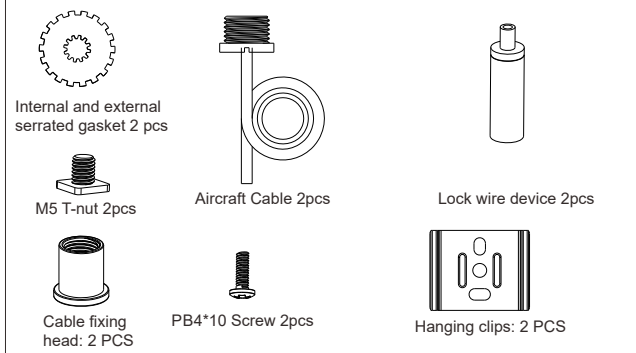

### AC input line list

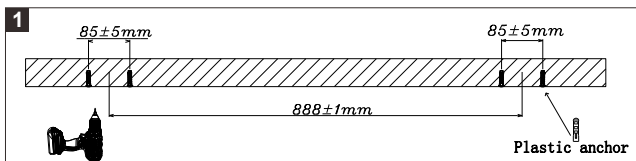

Punch holes in the appropriate position on the ceiling and insert plastic anchors

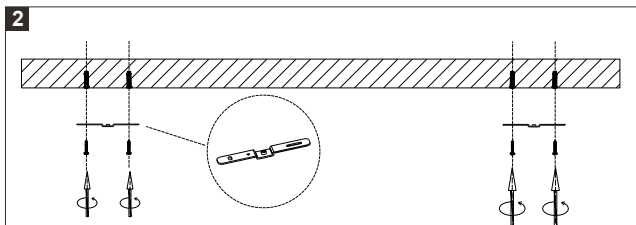

Fix the canopy mounting bracket to the ceiling

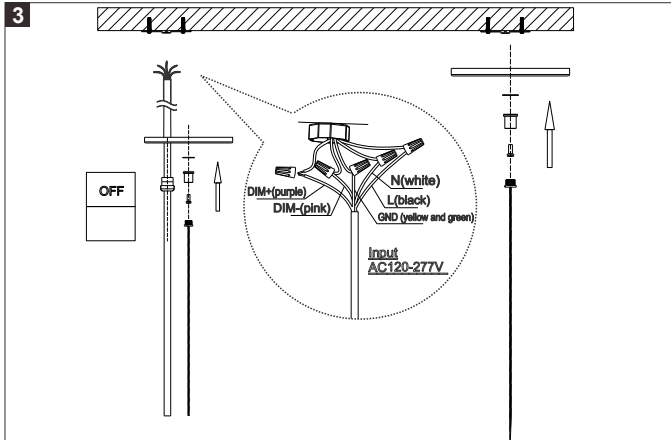

Remove the protective plate from the canopy, thread the power cable through the canopy, and plug it in. Once plugged in, secure it to the canopy using a cable tie. Then, install the lifting rope and the canopy onto the mounting bracket using the screws.

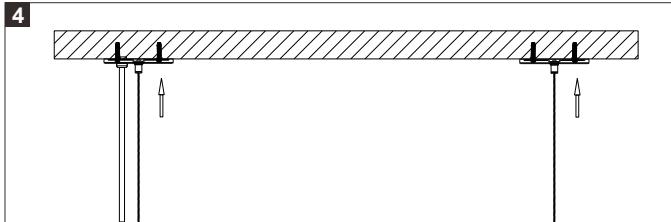

Schematic diagram after installing the canopy

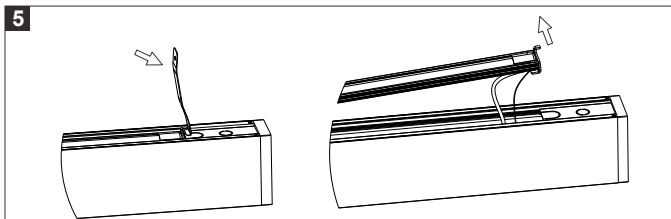

Open the upper light modular

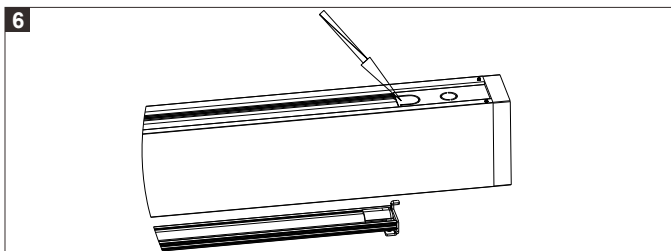

Cut the knockout hole with the Electrician's cutters

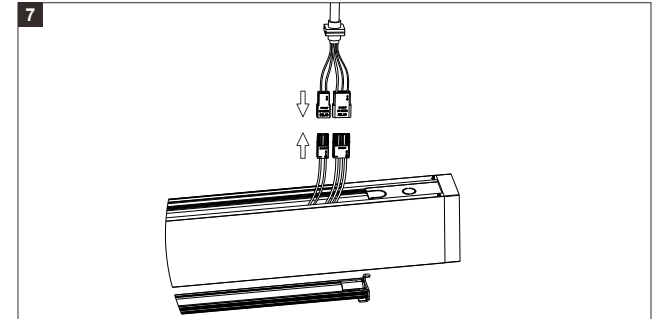

Connect the AC power cord with the inner linkable cable

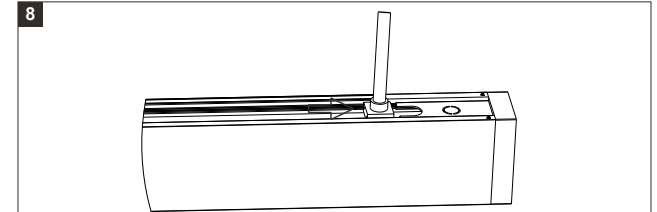

Fix the SR of the AC power cord

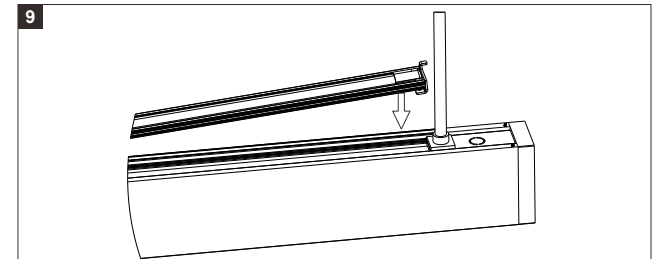

Install back the upper light modular on the fixture

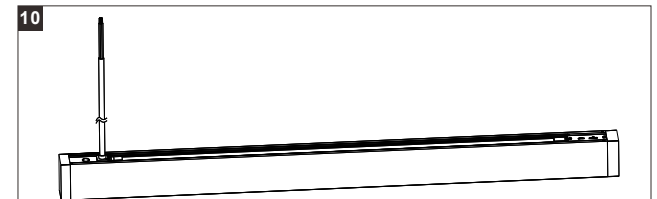

Lighting fixtures with connected AC input lines, as figure

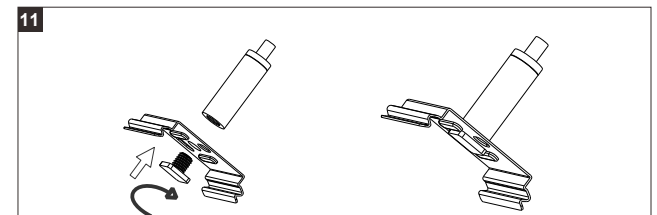

Assembly and lifting of the suspension clips and locking device, as illustrated

12

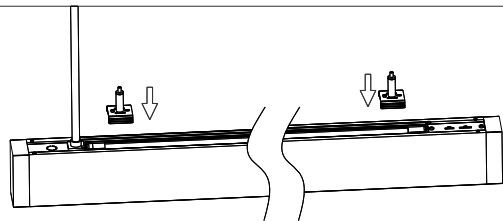

Buckle the lifting spring onto the lamp, as figure

13

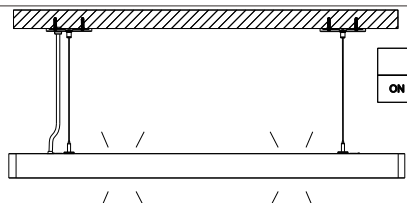

After installation is completed and confirmed to be correct, the switch can be turned on and used

### C) Junction

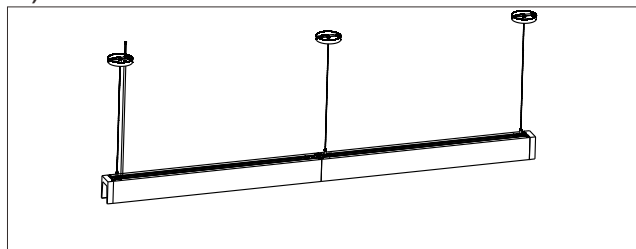

#### Installation Kits



light blocker 2 pcs



Junction bracket 1 pcs

1

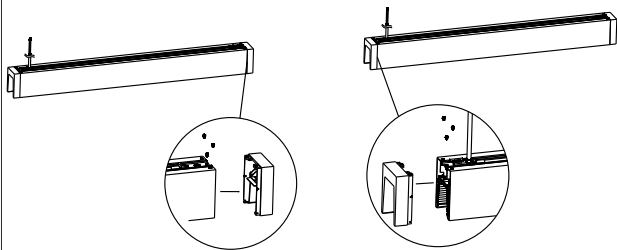

Disassemble the end cover

2



Install the light blockers and the junction pieces

3

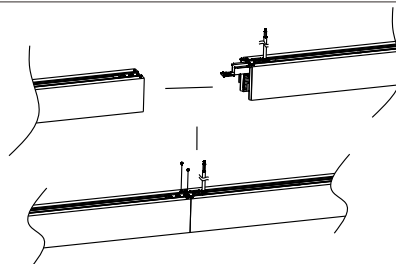

Lamp assembly and fixation

4

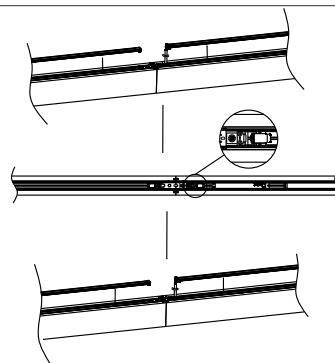

Remove the upper light-tightening snap, then reassemble the upper light.

5

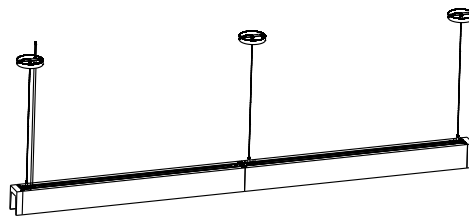

Complete the installation