

1.DESCRPTION:

This modern running man sign is developed with unique design,constructed of thermal plastic housing and PC pictogram sign ,ease of installation. High quality LED light source is distributed evenly on PC cover. Universal canopy included for rapid and simple installation. Remote head is changeable and can be rotated to certain angle.

2.CIRCUITRY:

	TLESPU01-UDC	TLESPU01-SP	Circuitry
AC120V 50/60Hz	Input Wattage: 2W	Input Wattage: 3W	<ul style="list-style-type: none">● Emergency duration: ≥ 2 Hours● Recharge time: 24 Hours● Output Wattage: 1W● Light Source: Ultra bright LED● Color temperature: 6000K-6500K● Ni-cad Battery: SP:3.6V 1000mAh SC● Product Size: 334*231*54mm
	Input Current:0.08A	Input Current:0.044A	
	Efficiency: 0.96P	Efficiency: 0.98P	
AC277V 50/60Hz	Input Wattage: 2.5W	Input Wattage: 3.5W	
	Input Current:0.08A	Input Current:0.044A	
	Efficiency: 0.92P	Efficiency: 0.93P	
AC347V 50/60Hz	Input Wattage: 3W	Input Wattage: 4W	
	Input Current:0.08A	Input Current:0.044A	
	Efficiency: 0.91P	Efficiency: 0.92P	
Emergency UDC Wattages as Follows: 6V-24V:1 W			

3.PRODUCT SIZE:

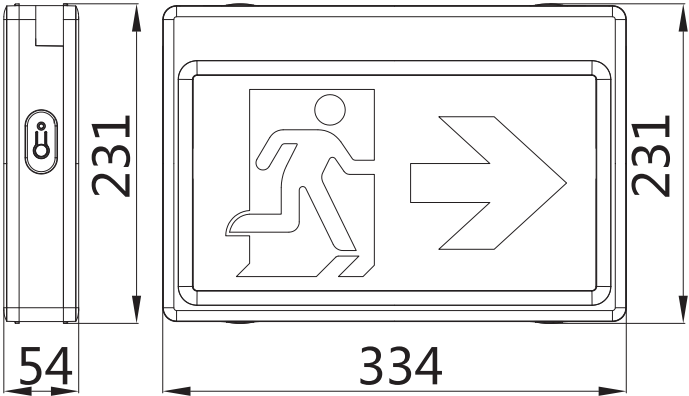

4.ATTENTION:

- 4.1. When using electrical equipment,basic safety precautions should always be followed,including the following:
- 4.1.1 Read and follow all safety instructions.
 - 4.1.2 Disconnect power before performing work on electrical equipment.
 - 4.1.3 Do not use outdoors.
 - 4.1.4 Do not let power cords touch hot surfaces.
 - 4.1.5.Do not install in hazardous locations or near gas or electric heaters.
 - 4.1.6 The use of accessory equipment not recommended by manufacturer, may cause and will void the unit's warranty.
 - 4.1.7 Do not use this equipment for other than its intended purpose.
 - 4.1.8 Servicing of this equipment should be performed by qualified service personnel.
 - 4.1.9. Equipment should be mounted in locations and at heights where it will not readily be subjected to tampering by unauthorized personnel.
 - 4.10. Allow battery to charge for 24 hours before first use.

5.INSTALLATION INSTRUCTIONS:

- The fixture suitable for wall mounting, side mounting, ceiling mounting.
For all mounting, attach crossbar to junction box
Wall Mount (See Fig.4.1;Fig.5)
5.1. Open front cover by flat screwdriver (see Fig.4.1).
5.2. If remote heads need to be assembled, make assembly as Fig.4.3.

PLASTIC RUNNING MAN INSTRUCTIONS

5.3. Knockout the appropriate mounting hole cover on the back plate(Fig 5).
route the proper wire through mounting hole out of housing. Make electrical connections inside the J-Box as wiring diagram (Fig. 1) Push excess wire into J-Box, mount back plate on the wall.

5.4. Attach battery connector to PCB, put back the front panel on unit.

5.5. If pictogram direction assembled not suitable, pictogram can take out for change direction or replace pictogram, and then insert into the diffuser easily.(Fig. 4.2)

Side Mount and Ceiling Mount (see Fig.6;Fig.7)

5.6. For ceiling and side mounting purpose, knock out the mounting hole cover on the top or side of the unit, assemble the canopy.

5.7. Route the proper wires through mounting hole out of housing. Make electrical connections inside the junction box as wiring diagram(Fig.1) Push excess wire into J-Box,use screws tighten canopy to crossbar so that canopy is securely fastened and tight against the wall.

Fig.1

WIRING DIAGRAM

AC Wiring

Working voltage:AC120V-347V 50Hz/60Hz

Black Wire (L)

White Wire (N)

UDC Wiring

Yellow wire:6V to 24V/DC positive(+)

Purple wire:Negative(-).

AC and UDC cannot be imported simultaneously

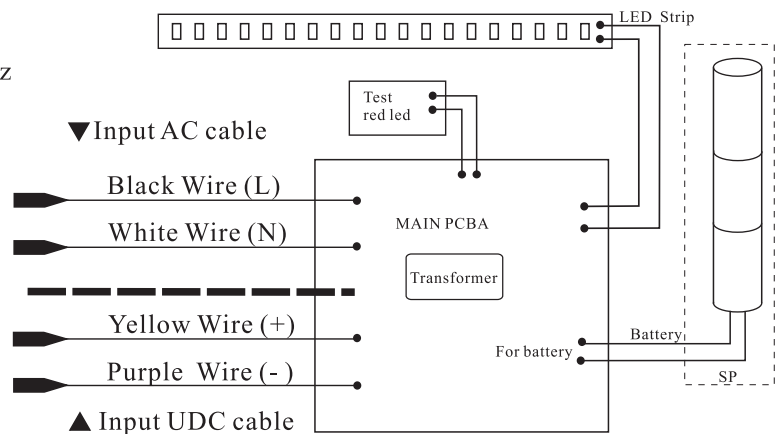

A C / S P W I R I N G

Black Wire (L)

AC120V-347V

White Wire (N)



U D C Wiring Diagram

Black Wire (L)

AC120V-347V

White Wire (N)

Yellow wire:6V to 24V/DC(+)

Purple wire:Negative(-).

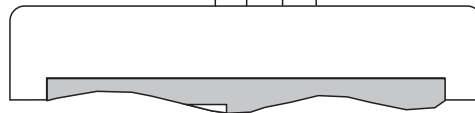

Fig.2

Canopy Assembly

Insert canopy into housing at 20 degree angle and twist it to lock firmly.

CAUTION:

Trying to remove canopy after it is locked in place may cause damage.

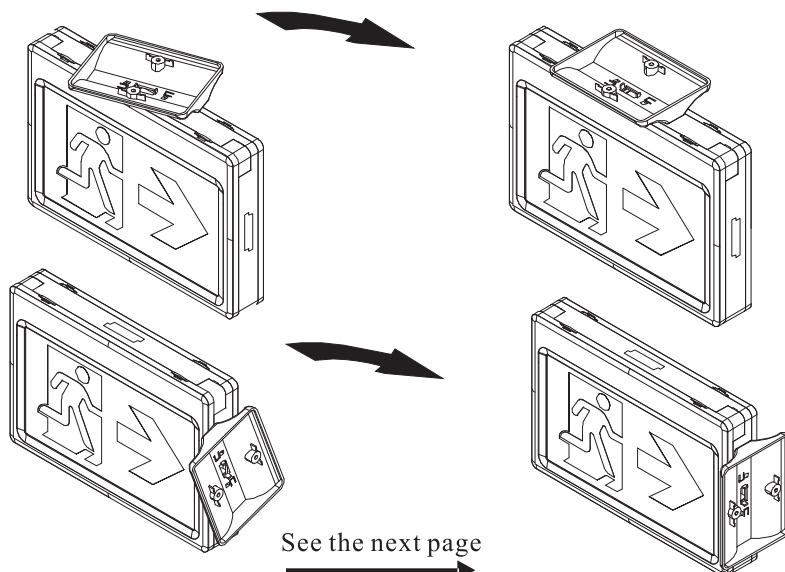

See the next page

PLASTIC RUNNING MAN INSTRUCTIONS

Fig.4.1

Open Front cover

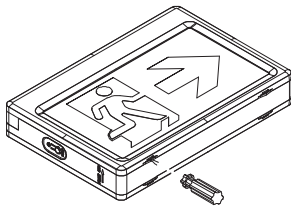

Fig.4.2

Change direction of pictogram

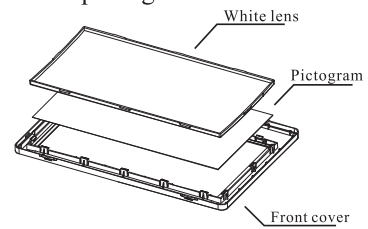

Fig.5

WALL MOUNTING WITH BACK PLATE

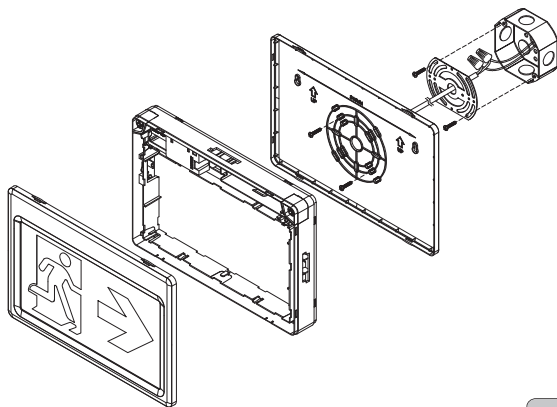
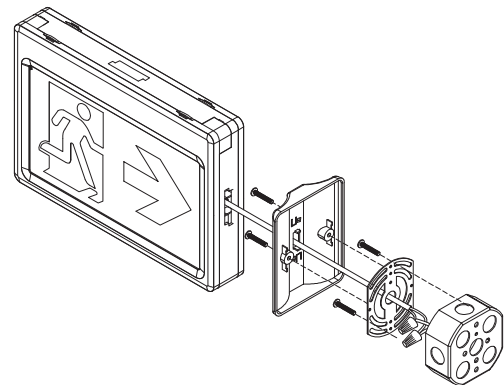

Fig.6

SIDE MOUNTING



The frosted side of the pictogram should be facing out

Fig.7

CEILING MOUNTING

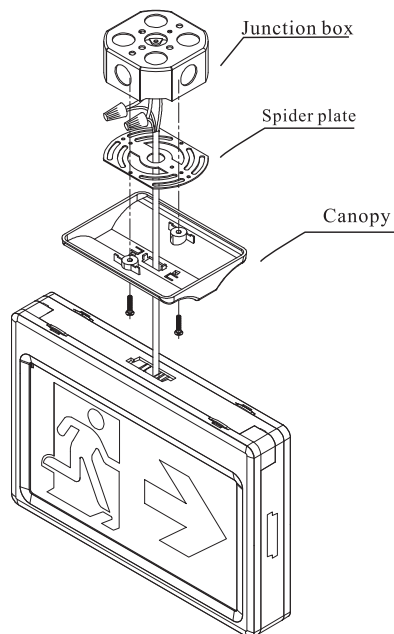

NOTE: The frosted side of the pictogram should be facing out

PLASTIC RUNNING MAN INSTRUCTIONS

6.TESTING:

To test, depress test switch. For running man signs the LED's should remain on under battery power. For running man combination units the emergency lamps will illuminate. When switch is released, lamps will go off. Allow 24 hours charging before full load testing.

7.MAINTENANCE:

None required, however unit should be tested periodically in accordance with NEC, Life Safety and other applicable codes. If unit fails to operate as described, disconnect battery and AC circuit, and check all wiring. Contact either the factory or trained service personnel if further assistance is required.

8.IMPORTANT NOTICE:

Combination units are furnished with a low voltage disconnect circuits to prevent damage by over discharging the battery. However, if the AC supply is to be disconnected for a prolonged period, the battery **MUST BE DISCONNECTED.**