

Specifications TLHBNU200PS

Electrical Specifications

Model No.	TLHBNU200PS
DLC ID	PLCLHKH2KDMJ
Power (W) ± 10%	200 W
Input Voltage (V)	AC100-347V, 50/60Hz
Efficacy ± 3%	146 lm/W
Power Factor (PF)	0.9
Total Harmonic Distorsion	≤15%

Photometric Specifications

CRI	80
CCT	5 000 K
Beam angle	115°
Light Output ± 3%	29 200 lm
Dimmable	0-10V

Mechanical Specifications

IP Rating	IP66 / IP69K / NEMA 4X
Material	Aluminum
Lens	Clear (Tempered glass)
Net Weight	5.75 kg
Product size (mm)	Ø434 x 192 mm
Product size (inch)	± Ø17 x 7-1/2 in
Operating Temperature	-40°C ~ 45°C
Lumen maintenance	>76% at 100 000 hours

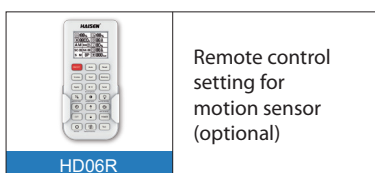

Built-in motion sensor

Maximum detection range	10 m (30 ft)
Ideal detection range	8 m (25 ft)

Product Description:

- Lightweight lamp body for easier installation in high ceiling areas. With epoxy paint, resistant to corrosion.
- Acid and alkaline resistant tempered glass lens.
- Built-in motion sensor. Remote control optional.
- 3/4" NPT mounting with hook included.
- Each lamp are with 2 m power cable.
- Other CCT available on special request.
- Over 70% energy savings compared to conventional lights with similar lumen output.
- Resistance to impact.
- NSF certified for use in the food industry.

Applications:

Food processing space, pharmaceutical factory, supermarket, farm, car wash, etc.

Installation with NPT 3/4" pipe

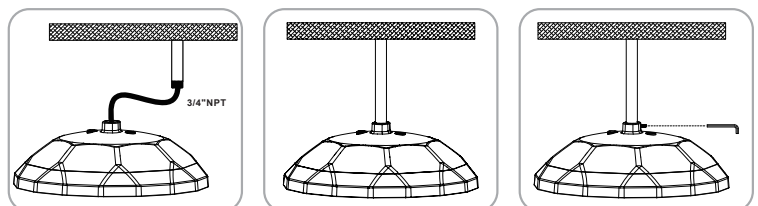

info@technilight.ca

WWW.TECHNILIGHT.CA