

TPPLUS14W50ADS

Technilight

PRO

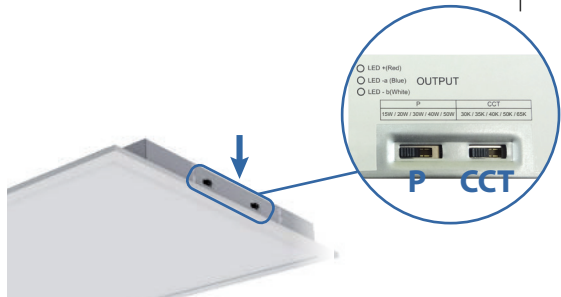
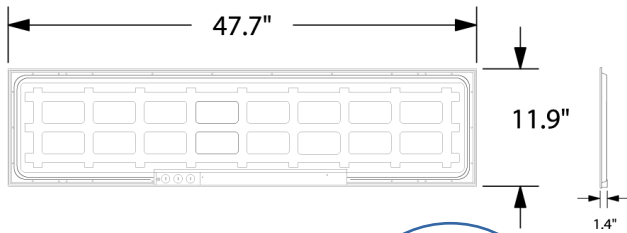

Specifications TPPLUS14W50ADS

Electrical Specifications

Model No.	TPPLUS14W50ADS
DLC ID	S-QCUKZL
Power (W) selectable	15W / 20W / 30W / 40W / 50W
Input Voltage (V)	AC120-347V, 50/60Hz
Efficacy ± 3%	135.2 lm/W
Power Factor (PF)	0.98
Total Harmonic Distortion	<10%





Photometric Specifications

CRI	82
CCT selectable	30K / 35K / 40K / 50K / 65K
Beam Angle	120°
Light Output ± 3%	Min.: 2 028 lm Max.: 6 760 lm
Dimmable	0-10 V

Mechanical Specifications

IP Rating	IP20
Material	Aluminum + metal sheet
Lens	Frosted PS
Net Weight	2.5 kg
Product size (mm)	± 1 194 x 279.4 x 25.4 mm
Product size (in)	± 47.7" x 11.9" x 1.4"
Operating Humidity	10% - 90%
Operating Temperature	-20°C ~ 40°C
Lumen maintenance	>82% at 100 000 hours

Optional accessories

 Surface installation frame 1' x 4' white TLPBL14WMF	 Recessed mounting frame 1' x 4' white TLPL14RMFWH	 6' suspension kit TLPBLSR
 Emergency battery BLD-HM15D	 Remote control for motion sensor HD06R	

Product description:

- Backlight LED panel luminaire.
- Selectable power and CCT with a switch.
- Motion and light sensor included.
- Seismic support included.
- Installation: suspended / suspended ceiling / surface mount with optional mounting frame.
- Type "IC".
- 0-10 V dimmable.
- Uniform brightness, high performance, low energy consumption and low radiant heat.
- Compatible with BLD-HM15D emergency battery.
- Warranty: 5 years.

Applications:

Office, business place, clinic, airport, commerce, hotel, basement, etc.

info@technilight.ca

WWW.TECHNILIGHT.CA