

# TPPLUS22W50ADS

**Technilight**

**PRO**

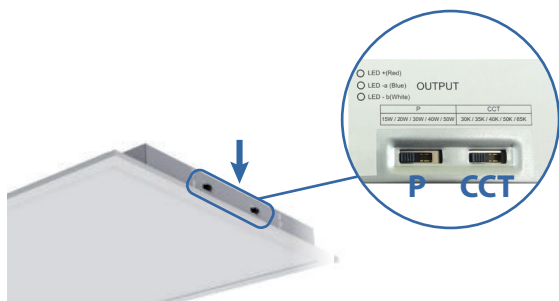
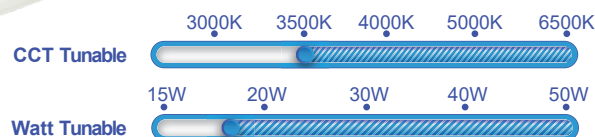
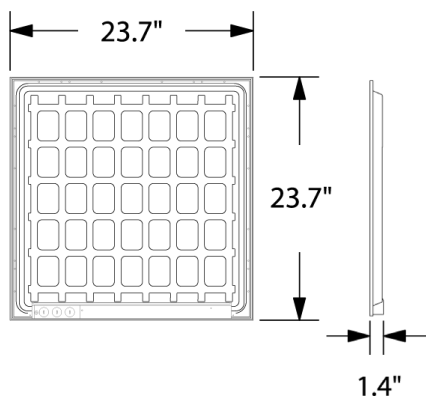

## Specifications TPPLUS22W50ADS

### Electrical Specifications

Model No.	TPPLUS22W50ADS
DLC ID	S-3C5H98
Power (W) selectable	15W / 20W / 30W / 40W / 50W
Input Voltage (V)	AC120-347V, 50/60Hz
Efficacy ± 3%	142.7 lm/W
Power Factor (PF)	0.98
Total Harmonic Distortion	<10%





### Photometric Specifications

CRI	82
CCT selectable	30K / 35K / 40K / 50K / 65K
Beam Angle	120°
Light Output ± 3%	Min.: 2 140 lm Max.: 7 135 lm
Dimmable	0-10 V

### Mechanical Specifications

IP Rating	IP20
Material	Aluminum + metal sheet
Lens	Frosted PS
Net Weight	2.5 kg
Product size (mm)	± 584 x 584 x 25.4 mm
Product size (in)	± 23.7" x 23.7" x 1.4"
Operating Humidity	10% - 90%
Operating Temperature	-20°C ~ 40°C
Lumen maintenance	>82% at 100 000 hours

### Optional accessories

 Surface installation frame 2' x 2' white <b>TLPBL22WMF</b>	 Recessed mounting frame 2' x 2' white <b>TLPL22RMFWH</b>	 6' suspension kit <b>TLPBLSR</b>
 Emergency battery <b>BLD-HM15D</b>	 Remote control for motion sensor <b>HD06R</b>	

### Product description:

- Backlight LED panel luminaire.
- Selectable power and CCT with a switch.
- Motion and light sensor included.
- Seismic support included.
- Installation: suspended / suspended ceiling / surface mount with optional mounting frame.
- Type "IC".
- 0-10 V dimmable.
- Uniform brightness, high performance, low energy consumption and low radiant heat.
- Compatible with BLD-HM15D emergency battery.
- Warranty: 5 years.

### Applications:

Office, business place, clinic, airport, commerce, hotel, basement, etc.

info@technilight.ca

**WWW.TECHNILIGHT.CA**