



TSBW5B

**5-function Bluetooth wall switch,
battery powered**



Description

The TSBW5B is a versatile, battery-powered Bluetooth wireless wall switch that provides seamless control of your Technilight Smart devices. It offers various functions, including ON/OFF, DIM+/DIM- for brightness adjustment, AUTO for automated control, and three customizable scenes. Additionally, the TSBW5B can function as a remote control, allowing you to control your Technilight Smart ecosystem from anywhere within its wireless range, ensuring reliable and secure Bluetooth communication.

Features

- Bluetooth 5.0 technology allows the switch to be connected to one or more lighting groups via the Technilight Smart app.
- Powered by a single CR2032 battery.
- 3-scene scroll button.
- Battery life: approximately 5 to 8 years*.
- Separate buttons: DIM+/DIM-, ON/OFF, AUTO.
- The LED indicator flashes when the battery is low.
- Can be mounted on a flat surface or electrical box, or used as a remote control.
- Easily retrofit existing wall switches with Decora wall plates.

* Based on a nominal lifespan of 5 years with 20 button presses per day.



RoHS



Specifications

Input Voltage	DC 3V
Bluetooth Transmit	100' Max
Radio Frequency	2.4GHz ± 75MHz
Bluetooth Version	5.0
Housing Material	UL 94-V0
Operating Temperature	-18°C ~ 50°C, -0.4°F ~ 122°F
Storage Temperature	0°C ~ 30°C, 32°F ~ 86°F
IP Rating	IP20
Color	White
Warranty	5 years
Compliance	UL1376, RoHS
Safety	DLC: coming soon

Dimensions

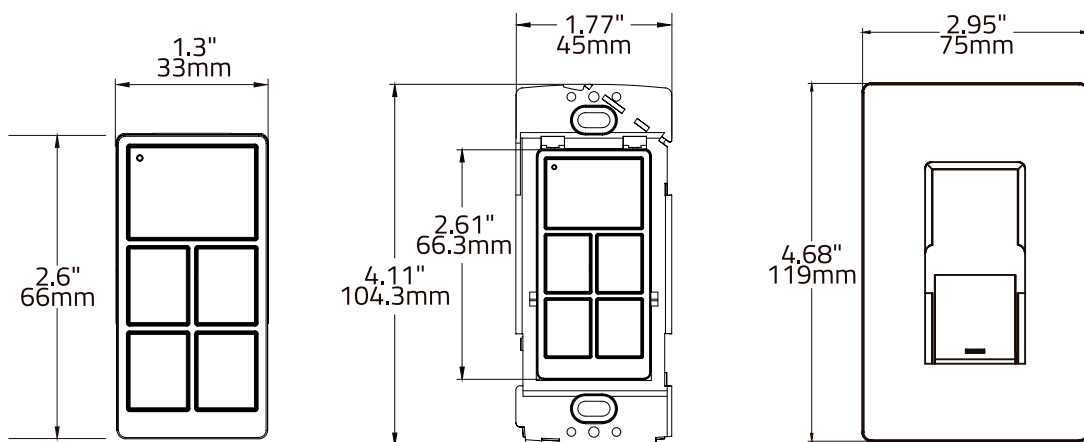

Product label

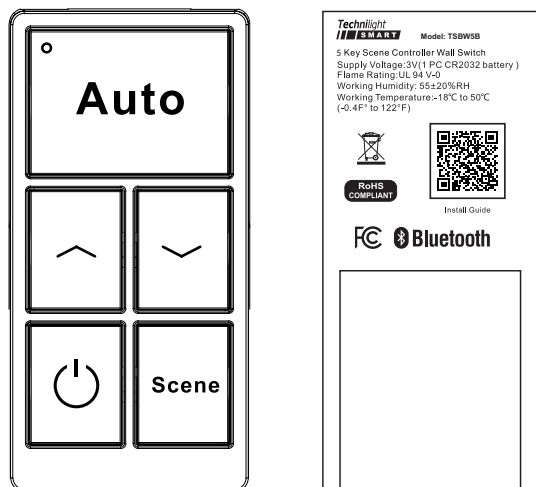

The Bluetooth word mark and logos are registered trademarks owned by Bluetooth SIG, Inc. and any use of such marks by Technilight Smart is under license.

Other trademarks and trade names are those of their respective owners.