

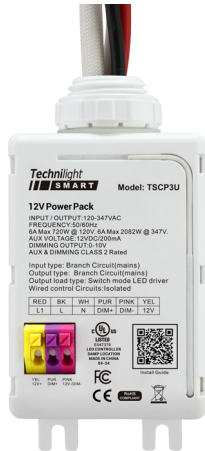

TSCP3U

Line Voltage 6A Relay Power Pack 12V Out



Description

The TSCP3U is a power supply unit providing a 12V DC output for powering sensors and switching dimmerless LED drivers. It also features a 0-10V dimming cable for two-stage motion control and a relay output.

Features

- The TSCP3U consists of a high-efficiency switching power supply and a 6A relay.
- The power supply turns connected loads on and off in response to Technilight Smart network sensors.
- Provides 12VDC and 200mA to power the sensor.
- Ideal for applications requiring high-voltage switching via low-voltage controls.
- The 1/2» threaded connection attaches to standard electrical boxes via 1/2» knockouts.



Specifications

Dimming	Class 2, 0-10V DC 10mA Max
Sinking Current	10mA Max
Output Voltage	120-347VAC
Output Power	6A Max 720W@120V, 1200W@277V, 2082@347V
Housing Material	UL 94-5VA
Operating Temperature	-30°C ~ 65°C, -22°F ~ 149°F
Storage Temperature	-30°C ~ 85°C, -22°F ~ 185°F
IP Rating	IP20
Color	White
Warranty	5 years
Compliance	UL8750, RoHS
Safety	cULus Listed LED Controller E547370

Dimensions

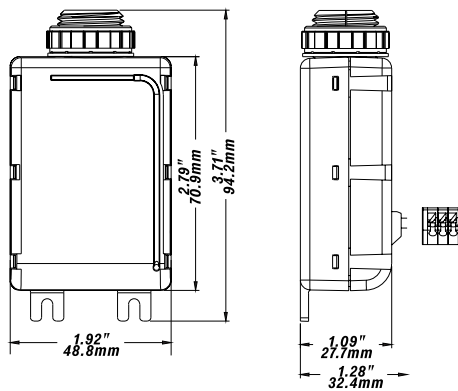

Fits a standard 1/2 inch NPT hole

Wiring

For single fixture

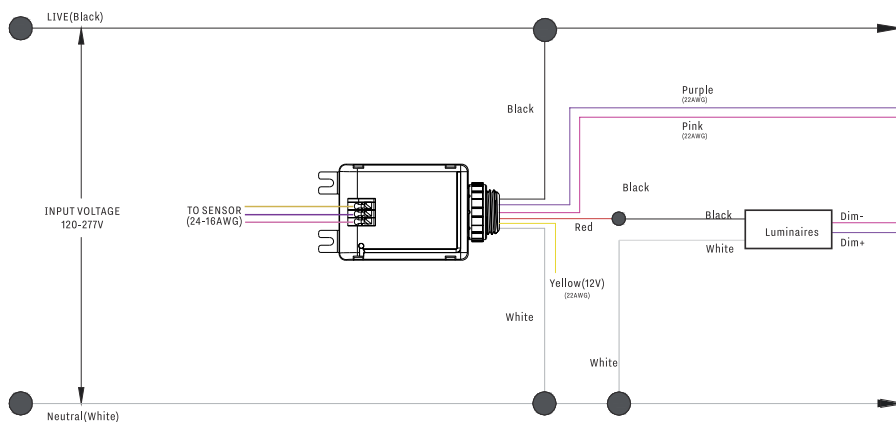

When connecting to multiple luminaires, ensure that the sum of the dimming dissipation currents used by all luminaires does not exceed the dimming dissipation current of this device.

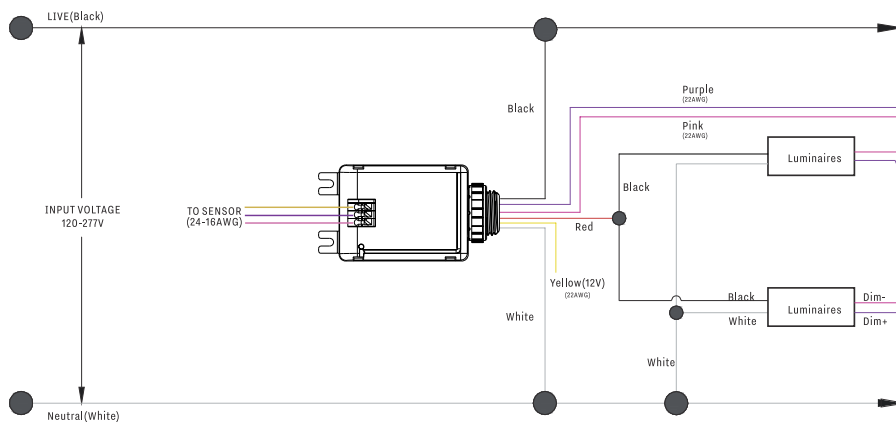

Information subject to change without notice. Pictures for illustration purpose only. rev. 2.5.4

Product label



The Bluetooth word mark and logos are registered trademarks owned by Bluetooth SIG, Inc. and any use of such marks by Technilight Smart is under license.

Other trademarks and trade names are those of their respective owners.