



## TSSDE3D

**12V Dual-Tech Ceiling / Wall Mount  
Eco Sensor**



### Description

The TSSDE3D motion sensor is a low-voltage, dual-technology wall or ceiling-mounted sensor combining PIR and ultrasonic technologies for high accuracy and wide coverage. It features the AlgoH2 algorithm to optimize detection while reducing false alarms. The TSSDE3D incorporates daylight harvesting and requires a lighting controller (TSBCP4AP or TSBCP2UP).

### Features

- 12V DC input.
- Powered by lighting controllers (TSBCP4AP or TSBCP2UP).
- Wall or ceiling mounting.
- Dual PIR + ultrasonic technology provides high accuracy and wide coverage.
- The AlgoH2 algorithm optimizes detection and reduces false alarms.

### Configuration require

- TSBCP4AP or TSBCP2UP luminaire controller.
- TSRJ45C cable required (sold separately).

### Specifications

<b>Input voltage</b>	DC 12V
<b>Housing material</b>	UL 94-V0
<b>Indoor / outdoor Use</b>	Indoor only
<b>Operating temperature</b>	-30°C ~ 55°C, -22°F ~ 131°F
<b>Storage temperature</b>	-30°C ~ 85°C, -22°F ~ 185°F
<b>IP Rating</b>	IP20
<b>Color</b>	White
<b>Warranty</b>	5 years
<b>Compliance</b>	RoHS
<b>Safety</b>	DLC: coming soon

## Ordering information

Model	Description
TSSDE3D	12V Dual-Tech Ceiling/Wall Mount Eco Sensor, PIR and Ultrasonic, Daylight Harvesting

## Ordering information - accessories

Model	Voltage	Connections	Description
TSBCP4AP	120-277V	Eco-Port / wire terminals	20A Luminaire Controller with Eco-Port
TSBCP2UP	120-347V	Eco-Port	6A Luminaire Controller with Eco-Port
TSRTP	N/A	RJ45 Eco-Port / PH2.0	Converter from RJ45 to PH2.0 connector
TSRJ45C10/25/50	N/A	N/A	CAT5e cable with RJ45 male connector on each end

## Wiring

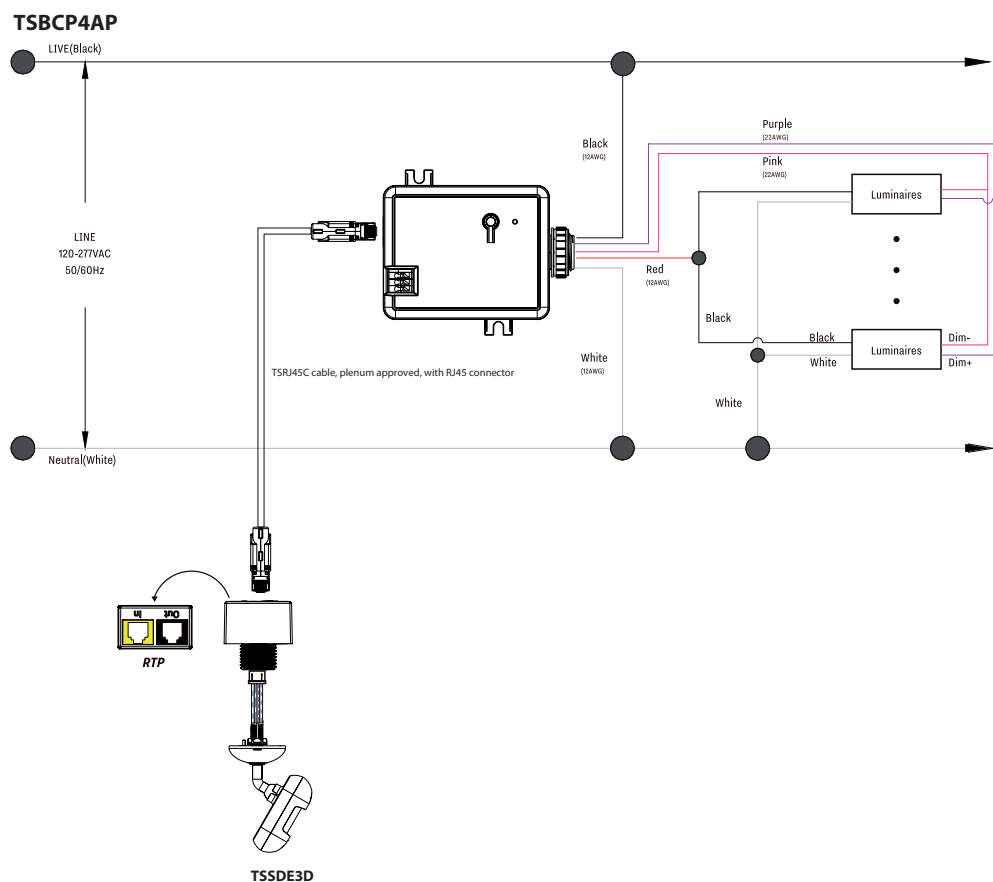

Information subject to change without notice. Pictures for illustration purpose only. rev. 2.5.11

## Wiring

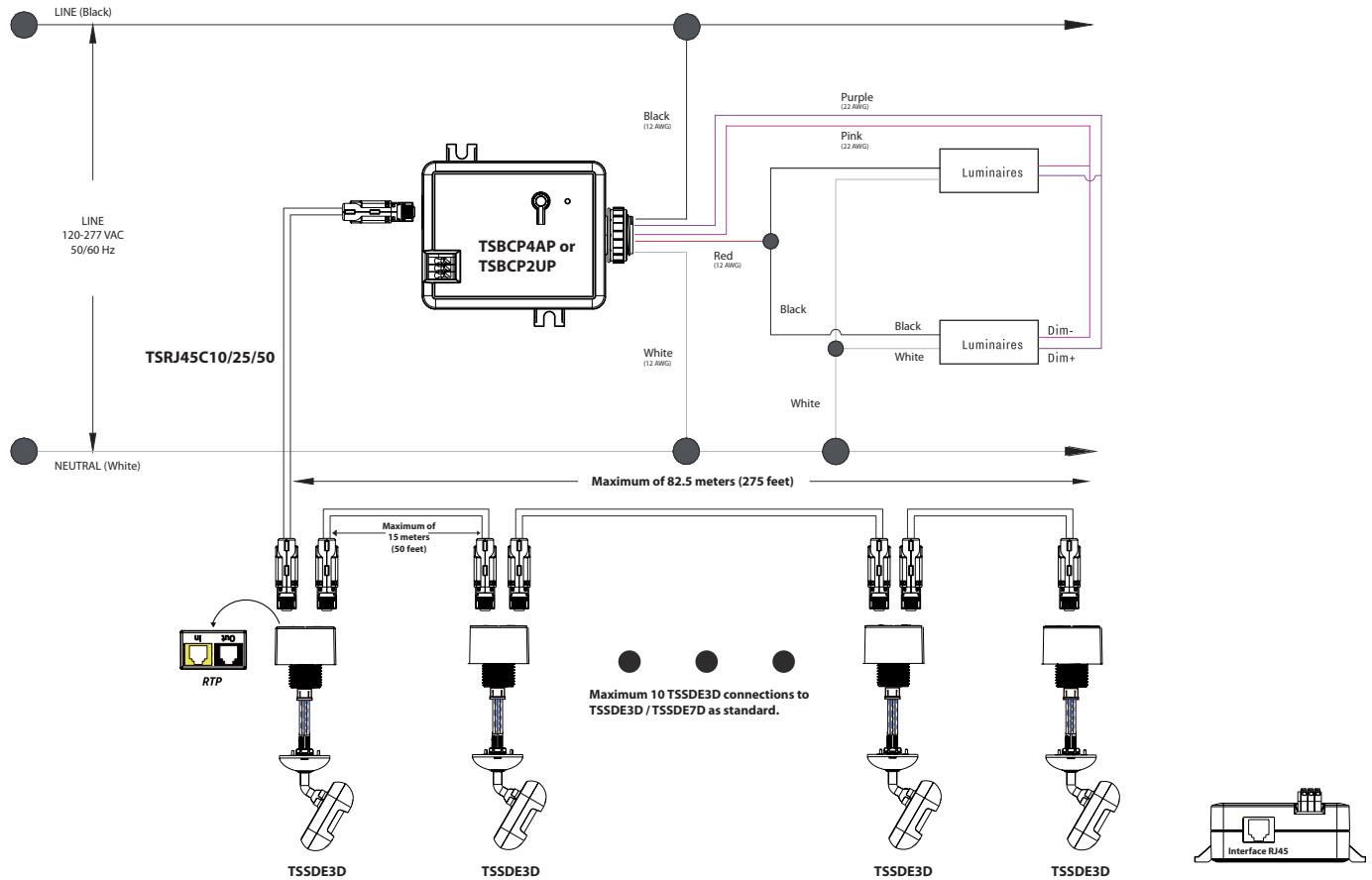

### TSBCP2UP

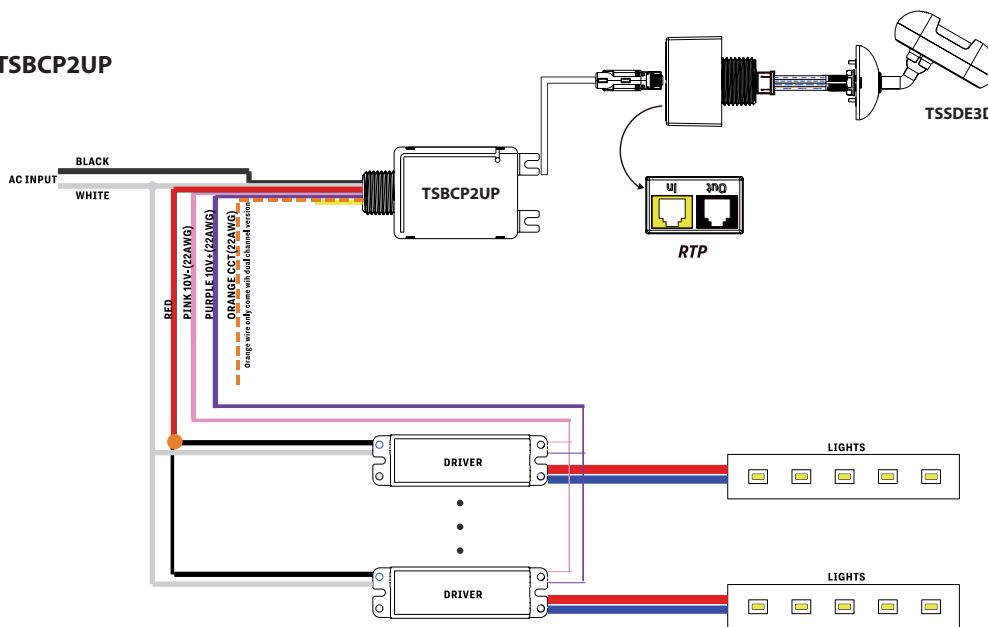

Information subject to change without notice. Pictures for illustration purpose only. rev. 2.5.11

PIR + Ultrasonic coverage top view

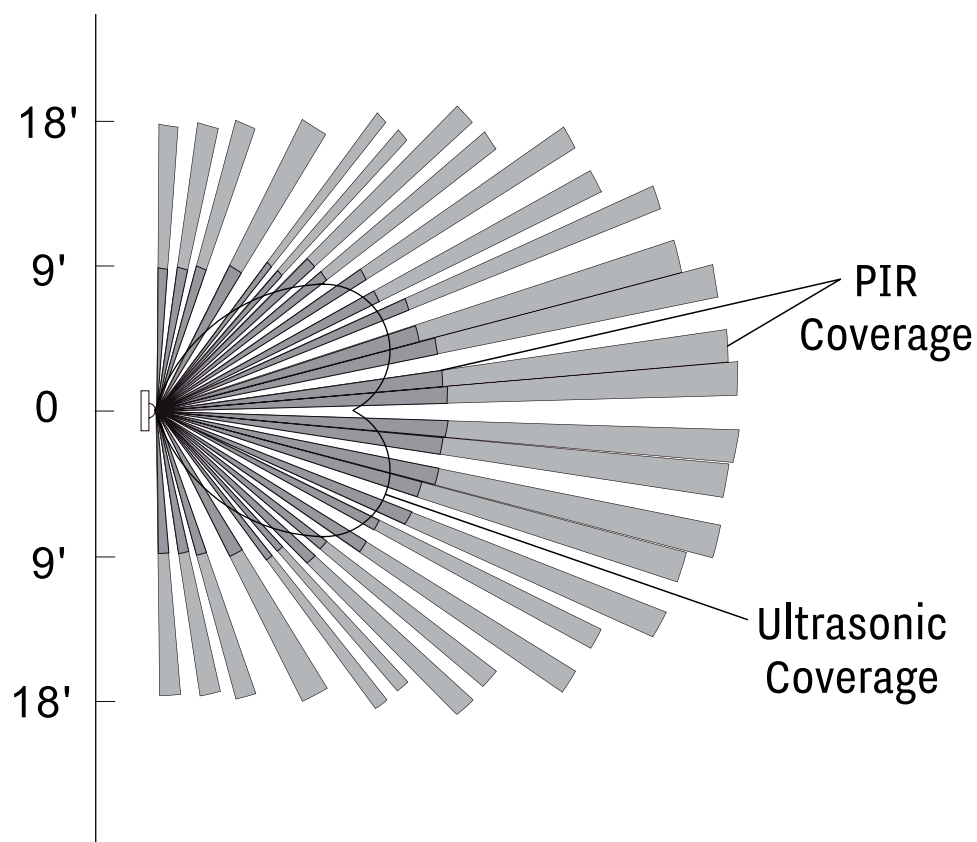

PIR Coverage Side View

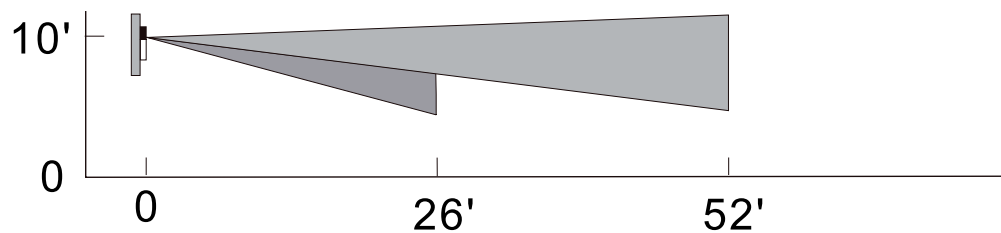

## Dimensions

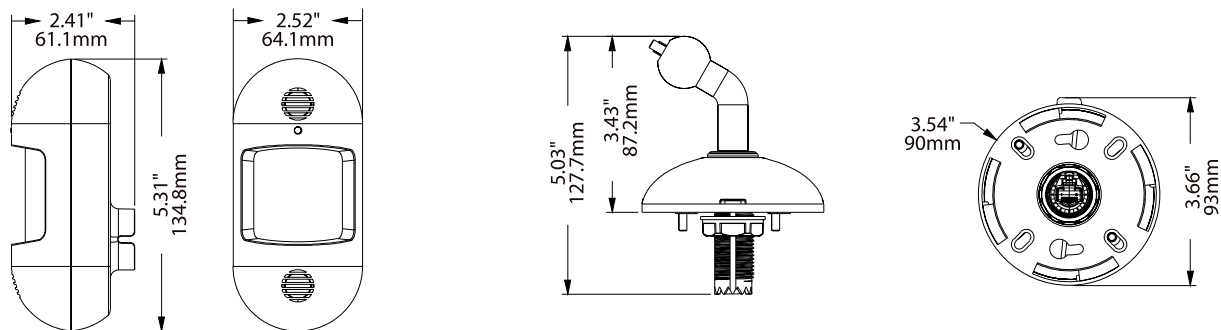

## Product label

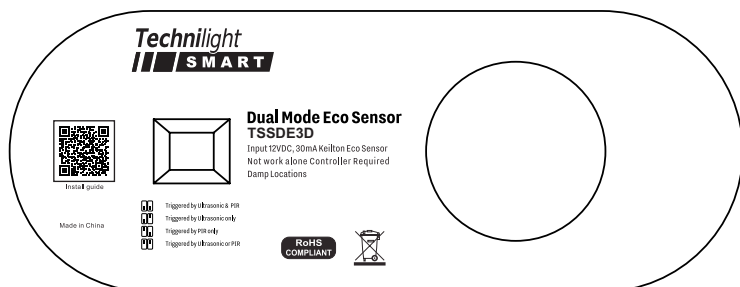

The Bluetooth word mark and logos are registered trademarks owned by Bluetooth SIG, Inc., and their use by Technilight Smart is under license.

## Application



Technilight Smart  
 Google play  
 Android

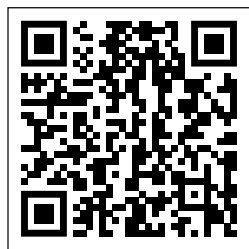

Technilight Smart  
 Apple store  
 iOS

Information subject to change without notice. Pictures for illustration purpose only. rev. 2.5.11