

Canopy

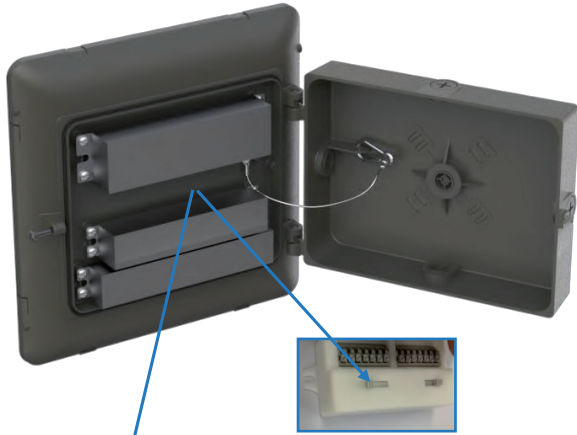

CCT adjustable (3000K, 4000K, 5000K)
Watt adjustable



Specifications TLCAUSF70ABK

Electrical Specifications

Model No.	TLCAUSF70ABK
DLC ID	S-2GKUHL
Power (W) ± 10% adjustable	35 W / 52 W / 70 W
Input Voltage (V)	120-347 V, 50/60 Hz
Efficacy ± 3%	130 lm/W
Power Factor (PF)	0.9
Surge protection	4Kv
Total harmonic distortion	20%

Photometric Specifications

CRI	70	
CCT adjustable	3000K / 4000K / 5000K	
Beam angle	120°	
Light Output ± 3%	35W: 4550 lm	52W: 6760 lm
	70W: 9100 lm	
Dimmable	0-10V	

Mechanical Specifications

IP Rating	IP65
Material	Aluminum
Lens	Frosted (Glass)
Net Weight	2.8 kg
Product size (mm)	± 268 x 268 x 77.5 mm
Product size (inch)	± 10.6 x 10.6 x 3.1 in
Operating Humidity	10% - 90%
Operating Temperature	-40°C ~ 45°C
Lifespan (L70)	60 000 hours

Accessories not included

	Wire guard		Bird guard
	Presence detector		Remote control setting for presence detector

Product description:

- Large supply voltage range 120-347V.
- 3000K / 4000K / 5000K adjustable CCT.
- 35W / 52W / 70W adjustable power.
- Lightweight lamp body for easier installation in high ceiling areas.
- Smooth surface structure prevents accumulation of water, dust and insects.
- Optional motion sensor.
- Remote control for motion sensor optional.
- Big energy saving compared to conventional lights with similar lumen output.

Applications:

Garages, gas stations, lean-to, stairwells, etc.